

DETAILED ESTIMATE

(AS PER PWD SSR 2021-22)

FOR

PRO - CON AGRO PRODUCER COMPANY LIMITED

TOTAL AMOUNT (Rs.) = 85.07 LAKHS

* NAME OF WORK *

PROPOSED CONSTRUCTION OF DAL MILL SHED IN SURVEY NO.- 4,
AT KESAPURI SHIVAR, TQ. MAJALGAON , DIST. BEED

S. S. Pangave

S. S. Pangave

(B.E. Civil)

Consulting Civil Engineer

T. P. Latur / 643 / 2019

Mob. 8552085000

CONSULTANT

PRO - CON AGRO PRODUCER COMPANY LIMITED
SURVEY NO.- 23, AT BHATWADGAON, TQ. MAJALGAON , DIST. BEED

**NAME OF WORK :- PROPOSED CONSTRUCTION OF DAL MILL SHED IN SURVEY
NO.- 4, AT KESAPURI SHIVAR, TQ. MAJALGAON , DIST. BEED**

RECAPULATION SHEET

Sr. No.	Particulars	AMOUNT(Rs.)
1	Cost of Work	7156027.00
2	Royalty Charges	186527.36
3	Material lab testing charges	23205.00
	Total	7365759.36
4	Add 3% contingencies	220972.7808
5	Add 12% GST	883891.1233
6	Add 0.50 % Labour Insurance	36828.80
	Grand Total	8507452.06

Pangave

S. S. Pangave
(E.E. Civil)
Consulting Civil Engineer
T. P. Latur / 643 / 2019
Mob. 8562085000

PRO - CON AGRO PRODUCER COMPANY LIMITED
SURVEY NO.- 23, AT BHATWADGAON, TQ. MAJALGAON , DIST. BEED

NAME OF WORK :- PROPOSED CONSTRUCTION OF DAL MILL SHED IN SURVEY NO.- 4, AT KESAPURI SHIVAR, TQ. MAJALGAON , DIST. BEED

MEASUREMENT SHEET

SR. NO.	DESCRIPTION OF ITEM	NO.	L	B	D	QTY.
1	Excavation for foundation in earth, soil of all types, sand, gravel and soft murum, including removing the excavated material up to a distance of 50 m. beyond the building area & (S.S.R. OF 2021-22 I.No. 21.02 P.No. 115)					
	FOR COLUMN FOOTING	20	1.80	1.50	1.500	81.000
	FOR STEPS	4	1.20	1.15	1.200	6.624
	FOR PLATFORM COL	8	1.50	1.50	1.500	27.000
	FOR DRYING PLATFORM	2	26.96	0.70	0.600	22.646
		2	13.80	0.70	0.600	11.592
	TOTAL QUANTITY					148.862
						Cu.M.
2	Excavation for foundation in hard murum including removing the excavated material upto distance of 50 metres beyond the (S.S.R. I.No. 21.06 P.No. 115)					
	FOR COLUMN FOOTING	20	1.80	1.50	0.600	32.400
	FOR STEPS	4	1.20	1.15	0.600	3.312
	FOR PLATFORM COL	8	1.50	1.50	0.600	10.800
	FOR DRYING PLATFORM	2	26.96	0.70	0.300	11.323
		2	13.80	0.70	0.300	5.796
	TOTAL QUANTITY					46.512
						Cu.M.
3	Providing and laying Cast in situ/Ready Mix cement concrete in M-10 of trap/ granite/ quartzite/ gneiss metal for foundation and bedding including bailing out water, formwork, (S. e-S.S.R. I.No. 24.01 P.No. 131					
	FOR COLUMN FOOTING	20	1.80	1.50	0.150	8.100
	FOR STEPS	4	1.20	1.15	0.150	0.828
	FOR PLATFORM	8	1.80	1.50	0.150	3.240
	FOR GODOWN	1	29.30	14.29	0.150	62.805
	FOR DRYING PLATFORM	2	26.96	0.60	0.150	4.853
		2	13.80	0.60	0.150	2.484
TOTAL QUANTITY					74.973	
						Cu.M.
4	Providing and laying in situ/Ready Mix cement concrete M-20 of trap/ granite/quartzite/gneiss metal for R.C.C.work in foundations like raft,strip foundations, grillage and footings of R.C.C.columns and steel stanchions etc.including bailing out (S- S.S.R. I.No. 25.11, P.No. 133)					
	FOR COLUMN FOOTING,	20	1.80	1.50	0.500	27.000
	FOR PLATFORM	8	1.50	1.20	0.450	6.480
	TOTAL QUANTITY					33.480
						Cu.M.
5	Providing and laying Cast in situ /Ready Mix cement concrete M20 of trap /granite/quartzite/gneiss metal for R.C.C.columns as per detailed designs and drawing or as directed including (S- S.S.R. I.No. 25.31, P.No. 134)					
	FOR COLUMN FOOTING TO PLINTH	20	0.23	0.45	2.900	6.003
	FOR PLATFORM	8	0.23	0.38	2.750	1.923
	FOR COLUMN ABOVE PLINTH	20	0.23	0.45	3.350	6.935
	TOTAL QUANTITY					14.861
						Cu.M.
6	Providing and laying Cast in situ /Ready Mix cement concrete M20 of trap/granite/quartzite/gneiss metal for R.C.C. beams and lintels as per detailed designs and drawings or as directed (S- S.S.R. T.No. 25.50, P.No. 135)					
	GROUND LEVEL					
	LONG WALL	14	3.40	0.23	0.500	5.474
	SHORT WALL	6	4.32	0.23	0.500	2.981
	PLINTH LEVEL					

MEASUREMENT SHEET

SR. NO.	DESCRIPTION OF ITEM	NO.	L	B	D	QTY.
	LONG WALL	14	3.40	0.23	0.150	1.642
	SHORT WALL	6	4.32	0.23	0.150	0.894
	ADD FOR LINTEL LEVEL					
	LONG WALL	14	3.40	0.23	0.150	1.642
	SHORT WALL	6	3.40	0.23	0.150	0.704
	ADD TOP BRACING LEVEL					
	LONG WALL	14	3.40	0.23	0.450	4.927
	SHORT WALL	6	4.32	0.23	0.450	2.683
	TOTAL QUANTITY					20.947
						Cu.M.
7	Providing and laying Cast in situ /Ready Mix cement concrete M20 of trap/granite/ quartzite/gneiss metal for R.C.C. slab sand landings as per detailed designs and drawings including (S.S.R. I.No. 25.70, P.No. 135)					
	FOR PLATFORM	4	4.30	1.00	0.15	2.580
	TOTAL QUANTITY					2.580
						Cu.M.
8	Providing and laying Cast in situ./Ready Mix cement concrete M-20 of trap/granite/quartzite/gneiss metal for R.C.C. Chajja as per detailed designs and drawings including (S.S.R.I.No. 26.05, P.No. 137)					
	VENTILATOR CHAJJA	30	1.50	0.60	0.150	4.050
	TOTAL QUANTITY					4.050
						Cu.M.
9	Providing and fixing in position TMT-PE-500 bar reinforcement of various diameters for R.C.C .pile caps, footings, foundations, slabs,beams, columns ,canopies, staircase, (S.S.R. I.No.26.33, P.No. 139)					
	Footing	33.48	cum. @	80.00	kg/cum	2678.400
	Column	14.86	cum. @	100.00	kg/cum	1486.100
	Beam	20.95	cum. @	100.00	kg/cum	2094.700
	Chajja	4.05	cum. @	80.00	kg/cum	324.000
	Slab	2.58	cum. @	80.00	kg/cum	206.400
					TOTAL	6789.60
						KG
	TOTAL QUANTITY					6.790
						M.T.
10	Providing uncoursed rubble masonry of trap/granite/quartzite/gneiss stones in cement mortar 1:5 in foundation and plinth of inner walls/in plinth of external walls (S.S.R. I.No.28.01, P.No. 146)					
	FOR DRYING AND COOLING PLATFORM OF DAL	2	26.96	0.60	0.900	29.117
		2	13.80	0.60	0.900	14.904
	TOTAL QUANTITY					44.021
						CUM
11	Providing soling using 80mm. size trap metal in 15cm. layer including filling voids with crused sand/grit, ramming, watering etc. complete. Spec. no. As directed by Engineer in (S.S.R. I.No.21.40 P.No. 118)					
	BELOW FLOORING OF DAL MILL	1	26.50	14.29	0.150	56.803
	TOTAL QUANTITY					56.803
						CUM
12	Filling in plinth and floors with contractors material/ brought from out side and approved by Engineer incharge in layers of 15 cm to 20 cm including watering and compaction etc. (S.S.R.I.No. 21.37, P.No. 117)					
	BELOW FLOORING OF DAL MILL	1	26.50	14.29	1.100	416.554
	BELOW DRYING PLATFORM	1	24.56	12.60	0.900	278.510
	TOTAL QUANTITY					695.064
						Cu.M.
13	Providing masonry with conventional / Indian Standard type bricks in cement mortar 1:6 in foundation and plinth of inner walls / in plinth of external walls including bailing out water (S.S.R.I.No. 27.01, P.No.144					

MEASUREMENT SHEET

SR. NO.	DESCRIPTION OF ITEM	NO.	L	B	D	QTY.
	LONG WALL	14	3.40	0.23	1.100	12.043
	SHORT WALL	6	4.32	0.23	1.100	6.558
		TOTAL QUANTITY				18.601
						Cu.M.
14	Providing masonry with conventional / Indian Standard type bricks in cement mortar 1:6 in superstructure including striking joints, raking out joints, watering and scaffolding (S.S.R.I.No. 27.05, P.No. 144)					
	LONG WALL	14	3.40	0.23	2.950	32.297
	SHORT WALL	6	4.32	0.23	2.950	17.587
	DEDUCTIONS FOR VENTILATORS	-30	1.50	0.23	0.600	-6.210
	DEDUCTIONS FOR SHUTTER	-4	3.40	0.23	3.060	-9.572
		TOTAL QUANTITY				34.102
						Cu.M.
15	Providing internal cement plaster 6 mm thick in a single coat in cement mortar 1:4 without neeru finish to concrete surface in all positions including scaffolding and curing etc. complete. (S.S.R.I.No. 32.01, P.No. 153)					
	FOR CHAJJAS	30	2	1.50	0.60	54.000
		30	2	0.60	0.125	4.500
		30	1	1.50	0.125	5.625
		TOTAL QUANTITY				64.125
						Sq.M.
16	Providing internal cement plaster 20 mm thick in single coat in cement mortar 1:5 without neeru finish to concrete or brick surfaces, in all positions including scaffolding and curing etc. (S.S.R. I. No. 32.03 P. No. 153)					
	LONG WALL	2	26.50		3.350	177.550
	SHIRT WALL	2	14.29		3.350	95.743
	DEDUCTIONS FOR VENTILATOR	-30	1.50		0.600	-27.000
	DEDUCTIONS FOR SHUTTER	-4	3.40		3.060	-41.616
		TOTAL QUANTITY				204.677
						Sq.M.
17	Providing sand faced plaster externally in cement mortar using approved screened sand, in all positions including base coat of 15 mm thick in cement mortar 1:4 using waterproofing (S.S.R. I. No. 32.11 P. 153)					
	BELOW PLINTH LONG WALL	2	26.96		0.900	48.528
	SHIRT WALL	2	14.75		0.900	26.550
	ABOVE PLINTH LONG WALL	2	26.96		3.400	183.328
	SHIRT WALL	2	14.75		3.400	100.300
	DEDUCTIONS FOR VENTILATORS	-30	1.50		0.600	-27.000
	DEDUCTIONS FOR SHUTTER	-4	3.40		2.900	-39.440
		TOTAL QUANTITY				292.266
						Cu.M.
18	Providing and laying in situ cement concrete M20 with tremix treatment for 100 mm thickness for flooring with groove cutting of 4mm wide and 20mm deep with necessaryrefilling (S.S.R. I. No. 33.30 P. 158)					
	FOR GODOWN	1	26.50	14.29		378.685
	FOR DRYING PLATFORM OF DAL	1	26.96	15.00		404.400
		TOTAL QUANTITY				783.085
						SQM
19	Providing and applying white-wash in two coats on old/new plastered or masonry surfaces and asbestos cement sheets including scaffolding and preparing the surface by brushing (S.S.R. I. No. 32.34 P. 155)					
	GROUND FLOOR	QTY AS PER 6 MM & 20 MM PLASTER				268.802
		TOTAL QUANTITY				268.802
						Sq.M.
20	Providing & applying washable oil-bound distemper of approved colour and shade to old & new surfaces in two coat including scaffolding, preparing the surfaces, (excluding the (S.S.R.I.No. 36.11, P. No. 167)					
		QTY AS PER 6 MM & 20 MM PLASTER				268.802

MEASUREMENT SHEET

SR. NO.	DESCRIPTION OF ITEM	NO.	L	B	D	QTY.
		TOTAL QUANTITY				268.802
						SQ.M.
21	Providing and applying two coats of exterior weather shield paint of approved manufacture and of approved colour to the plastered surfaces including cleaning ,preparing the plaster (S.S.R.I.No. 35.26, P. No. 165)					
		QTY AS PER 6 MM & 12 MM PLASTER				292.266
		TOTAL QUANTITY				292.266
						Sq.M.
22	Providing & constructing Brick Masonry Inspection Chamber 60cm x 45cm x 90cm including 1:4:8 cement concrete foundation 1:2:4 cement concrete channels half (S.S.R. I.No. 42.10, P.No. 200)					
		4				4.000
		TOTAL QUANTITY				4.000
						NOS.
23	Providing and laying machine cut machine polished machine cut Kota stone slabs 20 to 25 mm thick for treads and risers of steps and staircases, with rounded nosing for the (S.S.R. I.No.33.18 P. No. 157)					
	BELOW STAIRS	16	1.20	0.30		5.760
		16	1.20		0.150	2.880
		TOTAL QUANTITY				8.640
						Sq.M.
24	Providing and fixing in position powder coated aluminium louvered windows / ventilator of various sizes with powder coating as per detailed drawing and specifications including (S.S.R. I.No.39.68 P. No. 188)					
	VENTILATOR	30	1.50		0.600	27.000
		TOTAL QUANTITY				27.000
						Sq.M.
25	Providing and fixing rolling shutter fabricated from steel laths of minimum thickness 0.9mm with lock plate of 3.15mm (S.S.R. I.No. 39.25 P. No. 164)					
	OPENING	4	3.40	2.90		39.440
		TOTAL QUANTITY				39.440
						Sq.M.
26	Providing and fixing self supporting steel roofing system for a Godown or a like made up of structural grade steel sheet of (S.S.R. I.No. 38.44 P. No. 231)					
	TURBO VENTILATOR	8				8.000
		TOTAL QUANTITY				NOS
27	Providing and fixing 45 cm wide mild steel ladder of 40mmx6mm mild steel flat stringers and steps of 18 mm dia. Mild steel bar for water tank including fixing itin(1:2:4)M-15 (S.S.R. I.No. 41.56 P. No. 198)					
	LADDER	8				8.000
		TOTAL QUANTITY				rmt
28	Conveying materials obtained from excavation including all lifts,laying in layers of 20cm. to 30cm.breaking clods,dressing to the required lines,curves,grades and section,watering and (S.S.R. I.No. 2.26 P. No. 24)					
	AS PER ITEM NO 1 & 2	195.37				195.374
		TOTAL QUANTITY				CUM
29	Providing preconstructional antitermite treatment as per I.S.6313(Part-II) by treating the top surface of plinth filling at the rate of 5 litres of emulsion concentrate at 1.0 percent of (S.S.R. I.No. 21.24 P. No. 117)					
	FOR GODOWN,	1	26.50	14.29		378.685
		TOTAL QUANTITY				SQM
30	Providing and fixing corrugated galvanised iron sheets of 0.63mm thick (24 B.W.G.) for roofing without wind tiles including fastening with galvanised iron screws and bolts,lead					

MEASUREMENT SHEET

SR. NO.	DESCRIPTION OF ITEM	NO.	L	B	D	QTY.	
	(S.S.R. I.No. 38.05 P. No. 171)						
	FOR WH	2	26.96	8.23		443.762	
	LONG WALL	2	26.96		5.790	312.197	
	SHORT WALL	2	14.75		5.790	170.805	
	FOR PLATFORM	4	4.30	1.20		20.640	
						947.403	
		TOTAL QUANTITY					SQM
31	Providing and fabricating structural steel work in rolled sections like joists, channels, angles, tees etc. as per detailed design and drawings or as directed including cutting, (S.S.R. I.No. 23.02 P. No. 129)						
	FOR TRUSS , ANGLE , GIRDER	947	25.00	KG/SQM		23685.085	
						23.685	
		TOTAL QUANTITY					MT
32	Compacting the hard murum side widths including laying in layers on each side with vibratory roller including artificial watering etc. complete. (S.S.R. I.No. 2.31 P. No. 24)						
	FOR MAIN WH BLDG	4	26.50	14.29		1514.740	
	DEDUCTION FOR O.S. METAL IN PLINTH						
	LONG WALL	-2	26.50	0.60		-31.800	
	SHORT WALL	-2	13.09	0.60		-15.708	
		TOTAL QUANTITY					1467.232
						SQM	
33	Compacting the subgrade/gravel/sizemetal (100 mm loose) layers for all widths with Power roller having weight 8 to 10 MT. including necessary, labour, materials and artificial watering complete. (S.S.R. I.No. 50.61 P. No. 250)						
	FOR MAIN WH BLDG	1	26.500	14.290	0.600	227.211	
	O.S.METAL ON PLINTH ALONG PERIPHERY - LONGWALL	2	26.500	0.600		31.800	
		2	13.090	0.600		15.708	
						274.719	
		TOTAL QUANTITY					SQM
34	Providing and fixing lightening conductor system comprising of erecting Air-Termination consisting of tubular copper rod of 25mm dia.1.2 mm thick with multiple point shead 1.2 mt.long(HeavyDuty) welded or clamped to G.I.pipe pole						
	FOR WH	15				15.000	
		TOTAL QUANTITY					15.000
						RMT	
35	ADA compliant modular Multilingual and tactile Emergency evacuation map of each floor indicating the current position of the viewer saying "YOU ARE HERE" of 15 mm height letter sin						
	Fire extinguishers	4				4.000	
		TOTAL QUANTITY					NOS
36	Laboratory test of construction material						
	1) BASIC TEST OF AGGREGATE					0.000	
	a) Water Absorption, Specific Gravity, Impact Value, Crushing Value.	1.00				1.000	
	b) Sieve Analysis.	1.00				1.000	
	c) Abrasion Value.	1.00				1.000	
	d) Flakiness Index & Elongation Index.	1.00				1.000	
	2) BRICKS						
	Water Absorption (Set of 5 Bricks), Compressive Strength(Set of 5 Bricks), Efflorescence (Set of 5 Bricks).	1.000				1.000	
	3) CONCRETE						
	a) Compressive Strength OF C.C_Cube (Set of 3 cubes).	1.000				1.000	
	b) Concrete Mix Design (With all Tests on basic materials)	1.000				1.000	
	4) STEEL						
	Steel bar testing upto 16 mm (set of 3 bars)(Tensile strength, %, Elongation, Yield Stress,Weight-Per Meter, Bend / Rebend Test, Proof Stress.)	1.000				1.000	

PRO - CON AGRO PRODUCER COMPANY LIMITED
SURVEY NO.- 23, AT BHATWADGAON, TQ. MAJALGAON , DIST. BEED

NAME OF WORK :- PROPOSED CONSTRUCTION OF DAL MILL SHED IN SURVEY NO.- 4, AT KESAPURI
SHIVAR, TQ. MAJALGAON , DIST. BEED

ABSTRACT SHEET

SR. NO.	DESCRIPTION OF ITEM	QUANTITY	RATE	UNIT	TOTAL AMOUNT
1	Excavation for foundation in earth, soil of all types, sand, gravel and soft murum, including removing the excavated material up to a distance of 50 m. beyond the building area & (S.S.R. OF 2021-22 I.No. 21.02 P.No. 115)				
	RATE ANALYSIS	148.862	193.00	Cu.M.	28730.00
2	Excavation for foundation in hard murum including removing the excavated material upto distance of 50 metres beyond the building area and stacking and spreading as directed, (S.S.R. I.No. 21.06 P.No. 115)				
	RATE ANALYSIS	46.512	212.00	Cu.M.	9861.00
3	Providing and laying Cast in situ/Ready Mix cement concrete in M-10 of trap/ granite/ quartzite/ gneiss metal for foundation and bedding including bailing out water, formwork, (S. e-S.S.R. I.No. 24.01 P.No. 131				
	RATE ANALYSIS	74.973	6682.94	Cu.M.	501040.00
4	Providing and laying in situ/Ready Mix cement concrete M-20 of trap/ granite/quartzite/gneiss metal for R.C.C.work in foundations like raft,strip foundations, grillage and footings of (S- S.S.R. I.No. 25.11, P.No. 133)				
	RATE ANALYSIS	33.480	7605.24	Cu.M.	254623.00
5	Providing and laying Cast in situ /Ready Mix.cement concrete M20 of trap /granite/quartzite/gneiss metal for R.C.C.columns as per detailed designs and drawing or as directed including (S- S.S.R. I.No. 25.31, P.No. 134)				
	RATE ANALYSIS	14.861	13997.76	Cu.M.	208021.00
6	Providing and laying Cast in situ /Ready Mix cement concrete M20 of trap/granite/quartzite/gneiss metal for R.C.C. beams and lintels as per detailed designs and drawings or as directed (S- S.S.R. I.No. 25.50, P.No. 135)				
	RATE ANALYSIS	20.947	12749.57	Cu.M.	267065.00
7	Providing and laying Cast in situ /Ready Mix cement concrete M20 of trap/granite/ quartzite/gneiss metal for R.C.C. slab sand landings as per detailed designs and drawings including (S.S.R. I.No. 25.70, P.No. 135)				
	RATE ANALYSIS	2.580	15209.57	Cu.M.	39241.00
8	Providing and laying Cast in situ /Ready Mix cement concrete M-20 of trap/granite/quartzite/gneiss metal for R.C.C. Chajja as per detailed designs and drawings including (S.S.R.I.No. 26.05, P.No. 137)				
	RATE ANALYSIS	4.050	14377.57	Cu.M.	58229.00
9	Providing and fixing in position TMT-FE-500 bar reinforcement of various diameters for R.C.C pile caps, footings, foundations, slabs,beams, columns ,canopies, staircase, (S.S.R. I.No.26.33, P.No. 139)				
	RATE ANALYSIS	6.790	71926.81	Cu.M.	488383.0
10	Providing uncoursed rubble masonry of trap/granite/quartzite/gneiss stones in cement mortar 1:6 in foundation and plinth of inner walls/in plinth of external walls including bailing out water manually striking joints on (S.S.R. I.No.28.01, P.No. 146)				
	RATE ANALYSIS	6.790	4757.00	Cu.M.	32300.0
11	Providing soling using 80mm. size trap meta in 15cm. layer including filling voids with crused sand/grit, ramming, watering etc. complete. Spec. no. As directed by Engineer in (S.S.R. I.No.21.40 P.No. 118)				
	RATE ANALYSIS	56.803	1677.50	CUM	95287.00

ABSTRACT SHEET

SR. NO.	DESCRIPTION OF ITEM	QUANTITY	RATE	UNIT	TOTAL AMOUNT
12	Filling in plinth and floors with contractors material/ brought from out side and approved by Engineer incharge in layers of 15 cm to 20 cm including watering and compaction etc. Complete (Spec No Bd A 11 page No 263) (S.S.R.I.No. 21.37, P.No. 117)				
	RATE ANALYSIS	695.064	874.34	Cu.M.	607722.00
13	Providing masonry with conventional / Indian Standard type bricks in cement mortar 1:6 in foundation and plinth of inner walls / in plinth of external walls including bailing out water manually, striking joints on unexposed faces, raking out joints (S.S.R.I.No. 27.01, P.No.144)				
	RATE ANALYSIS	18.601	9151.74	Cu.M.	170232.00
14	Providing masonry with conventional / Indian Standard type bricks in cement mortar 1:6 in superstructure including striking joints, raking out joints, watering and scaffolding (S.S.R.I.No. 27.05, P.No. 144)				
	RATE ANALYSIS	34.102	9378.74	Cu.M.	319834.00
15	Providing internal cement plaster 6 mm thick in a single coat in cement mortar 1:4 without neeru finish to concrete surface in all positions including scaffolding and curing etc. complete. As Directed By Engineer Incharge (S.S.R.I.No. 32.01, P.No. 153)				
	RATE ANALYSIS	64.125	228.46	Sq.M.	14650.00
16	Providing internal cement plaster 20 mm thick in single coat in cement mortar 1:5 without neeru finish to concrete or brick surfaces, in all positions including scaffolding and curing etc. (S.S.R. I. No. 32.03 P. No. 153)				
	RATE ANALYSIS	204.677	396.46	Sq.M.	81146.00
17	Providing sand faced plaster externally in cement mortar using approved screened sand, in all positions including base coat of 15 mm thick in cement mortar 1:4 using waterproofing (S.S.R. I. No. 32.11 P. 153)				
	RATE ANALYSIS	292.266	636.46	Sq.M.	186016.00
18	Providing and laying in situ cement concrete M20 with tremix treatment for 100 mm thickness for flooring with groove cutting of 4mm wide and 20mm deep with necessaryrefilling with bitumen etc. complete. (S.S.R. I. No. 33.30 P. 158)				
	RATE ANALYSIS	783.085	794.05	Sq.M.	621809.00
19	Providing and applying white-wash in two coats on old/new plastered or masonry surfaces and asbestos cement sheets including scaffolding and preparing the surface by brushing (S.S.R. I. No. 32.34 P. 155)				
	RATE ANALYSIS	268.802	11.00	Sq.M.	2957.00
20	Providing & applying washable oil-bound distemper of approved colour and shade to old & new surfaces in two coat including scaffolding, preparing the surfaces. (excluding the primer coat) etc. complete Spec No Bd P 5 Page No 413 (S.S.R.I.No. 36.11, P. No. 167)				
	RATE ANALYSIS	268.802	43.00	Sq.M.	11558.00
21	Providing and applying two coats of exterior weather shield paint of approved manufacture and of approved colour to the plastered surfaces including cleaning ,preparing the plaster (S.S.R.I.No. 35.26, P. No. 165)				
	RATE ANALYSIS	292.266	238.00	Sq.M.	69559.00
22	Providing & constructing Brick Masonry Inspection Chamber 60cm x 45cm x 90cm including 1:4:8 cement concrete foundation 1:2:4 cement concrete channels half As directed by Engineer in charge. (S.S.R. I.No. 42.10, P.No. 200)				
	RATE ANALYSIS	4.000	13315.36	Sq.M.	53261.00
23	Providing and laying machine cut machine polished machine cut Kota stone slabs 20 to 25 mm thick for treads and risers of steps and staircases, with rounded nosing for the				

ABSTRACT SHEET

SR. NO.	DESCRIPTION OF ITEM	QUANTITY	RATE	UNIT	TOTAL AMOUNT
	(S.S.R. I.No.33.18 P. No. 157) RATE ANALYSIS	8.640	1554.22	Sq.M.	13428.00
24	Providing and fixing in position powder coated aluminium louvered windows / ventilator of various sizes with powder coating as per detailed drawing and specifications including aluminium frames 80 x 38 mm x 1.22 mm box type, 5 mm (S.S.R. I.No.39.68 P. No. 188) RATE ANALYSIS	27.000	3107.00	Sq.M.	83889.00
25	Providing and fixing rolling shutter fabricated from steel laths of minimum thickness 0.9mm with lock plate of 3.15mm thickness reinforced with 35x35x5 mm angle section fitted (S.S.R. I.No. 39.25 P. No. 164) RATE ANALYSIS	39.440	4730.00	Sq.M.	186551.00
26	Providing and fixing self supporting steel roofing system for a Godown or a like made up of structural grade steel sheet of 912 millimeter width(tolerance+/-2millimeter),moulded at (S.S.R. I.No. 38.44 P. No. 231) RATE ANALYSIS	8.000	8680.00	Nos.	69440.00
27	Providing and fixing 45 cm wide mild steel ladder of 40mmx6mm mild steel flat stringers and steps of 18 mm dia. Mild steel bar for water tank including fixing itin(1:2:4)M-15 (S.S.R. I.No. 41.56 P. No. 198) RATE ANALYSIS	7.000	1151.00	RMT	8057.00
28	Conveying materials obtained from excavation including all lifts,laying in layers of 20cm. to 30cm.breaking clods,dressing to the required lines,curves,grades and section,watering and (S.S.R. I.No. 2.26 P. No. 24) RATE ANALYSIS	195.374	359.00	cum	70139.00
29	Providing preconstructional antitermite treatment as per I.S.6313(Part-II) by treating the top surface of plinth filling at the rate of 5 litres of emulsion concentrate at 1.0 percent of (S.S.R. I.No. 21.24 P. No. 117) RATE ANALYSIS	378.685	94.00	sqm	35596.00
30	Providing and fixing corrugated galvanised iron sheets of 0.63mm thick (24 B.W.G.) for roofing without wind tiles including fastening with galvanised iron screws and bolts,lead (S.S.R. I.No. 38.05 P. No. 171) RATE ANALYSIS	378.685	1042.00	sqm	394590.00
31	Providing and fabricating structural steel work in rolled sections like joists, channels, angles, tees etc. as per detailed design and drawings or as directed including cutting (S.S.R. I.No. 23.02 P. No. 129) RATE ANALYSIS	23.685	85585.00	sqm	2027088.00
32	Compacting the hard murum side widths including laying in layers on each side with vibratory roller including artificial watering etc. complete. (S.S.R. I.No. 2.31 P. No. 24) RATE ANALYSIS	1467.232	19.00	sqm	27877.00
33	Compacting the subgrade/gravel/sizemetal (100 mm loose) layers for all widths with Power roller having weight 8 to 10 MT. including necessary, labour, materials and artificial watering complete. (S.S.R. I.No. 50.61 P. No. 250) RATE ANALYSIS	274.719	25.00	sqm	6868.00
34	Providing and fixing lightening conductor system comprising of erecting Air-Termination consisting of tubular copper rod of 25mm dia.1.2 mm thick with multiple point shead 1.2 mt.long(HeavyDuty) welded or clamped to G.I.pipe pole Borade 50 mm dia of required length with M.S.round base RATE ANALYSIS	15.000	2132.00	RMT	31980.00
35	ADA compliant modular Multilingual and tactile Emergency evacuation map of each floor indicating the current position of the viewer saying "YOU ARE HERE" of 15 mm height letter sin (S.S.R. I.No. 51.74 P. No. 261)				

ABSTRACT SHEET					
SR. NO.	DESCRIPTION OF ITEM	QUANTITY	RATE	UNIT	TOTAL AMOUNT
	RATE ANALYSIS	4.000	19750.00	Nos.	79000.00
			TOTAL Rs.		7156027
36	Laboratory test of construction material				
	1) BASIC TEST OF AGGREGATE				
	a) Water Absorption, Specific Gravity, Impact Value, Crushing Value.	1.00	2600.00	Nos.	2600.00
	b) Sieve Analysis.	1.00	690.00	Nos.	690.00
	c) Abrasion Value.	1.00	1170.00	Nos.	1170.00
	d) Flakiness Index & Elongation Index.	1.00	850.00	Nos.	850.00
	2) BRICKS				
	Water Absorption (Set of 5 Bricks), Compressive Strength(Set of 5 Bricks), Efflorescence (Set of 5 Bricks).	1.000	2175.00	Nos.	2175.00
	3) CONCRETE				
	a) Compressive Strength OF C.C. Cube (Set of 3 cubes).	1.000	690.00	Nos.	690.00
	b) Concrete Mix Design (With all Tests on basic materials)	1.000	13755.00	Nos.	13755.00
	4) STEEL				
	Steel bar testing upto 16 mm (set of-3 bars)(Tensile strength, %, Elongation, Yield Stress, Weight-Per Meter, Bend / Rebend Test, Proof Stress.)	1.000	1275.00	Nos.	1275.00
			TOTAL Rs.		23205.00

S. S. Pangave
 (B.E. Civil)
 Consulting Civil Engineer
 T. P. Latur / 643 / 2019
 Mob. 8552085000

PRO - CON AGRO PRODUCER COMPANY LIMITED
SURVEY NO.- 23, AT BHATWADGAON, TQ. MAJALGAON , DIST. BEED

NAME OF WORK :- PROPOSED CONSTRUCTION OF DAL MILL SHED IN SURVEY NO.- 4, AT KESAPURI SHIVAR, TQ. MAJALGAON , DIST, BEED

RATE ANALYSIS AS PER PWD SSR 2021-22

SR. NO.	DESCRIPTION OF ITEM	QTY.	NET LEAD CHARGES	RATE
1	Excavation for foundation in earth, soil of all types, sand, gravel and soft murum, including removing the excavated material up to a distance of 50 m. beyond the building area & stacking and spreading as directed. (S.S.R. OF 2021-22 I.No. 21.02 P.No. 115)			193.00
	TOTAL RATE Rs.			193.00 PerCu.M.
	2	Excavation for foundation in hard murum including removing the excavated material upto distance of 50 metres beyond the building area and stacking and spreading as directed, dewatering, preparing the bed for (S.S.R. I.No. 21.06 P.No. 115)		
	TOTAL RATE Rs.			212.00 PerCu.M.
3	Providing and laying Cast in situ/Ready Mix cement concrete in M-10 of trap/ granite/ quartzite/ gneiss metal for foundation and bedding including bailing out water, formwork, laying/pumping, compacting, (S. c-S.S.R. I.No. 21.01 P.No. 131			5538.00
	ADD LEAD CHARGES FOR CEMENT	0.22000	148.81	32.74
	ADD LEAD CHARGES FOR SAND	0.47000	973.59	457.59
	ADD LEAD CHARGES FOR CR METAL	0.24000	355.50	85.32
	ADD LEAD CHARGES FOR 40MM METAL CB	0.70000	340.69	238.48
	@ADD DIFF.COST FOR SAND	0.47000	825.00	387.75
	@ADD DIFF.COST FOR 20MM METAL	0.24000	174.00	41.76
	@ADD DIFF.COST FOR 40MM METAL CB	-0.70000	141.00	-98.70
	TOTAL RATE Rs.			6682.94 PerCu.M.
	4	Providing and laying in situ/Ready Mix cement concrete M-20 of trap/ granite/quartzite/gneiss metal for R.C.C.work in foundations like raft,strip foundations, grillage and footings of R.C.C columns and steel (S- S.S.R. I.No. 25.11, P.No. 133)		
ADD LEAD CHARGES FOR CEMENT		0.35000	148.81	52.08
ADD LEAD CHARGES FOR SAND		0.44000	973.59	428.38
ADD LEAD CHARGES FOR CR METAL		0.33000	355.50	117.32
@ADD DIFF.COST FOR SAND		0.44000	825.00	363.00
@ADD DIFF.COST FOR 20MM METAL		0.22000	174.00	38.28
@ADD DIFF.COST FOR 12MM METAL		0.11000	174.00	19.14
@ADD DIFF.COST FOR 40MM METAL CB		-0.56000	141.00	-78.96
TOTAL RATE Rs.				7605.24 PerCu.M.
5		Providing and laying Cast in situ /Ready Mix cement concrete M20 of trap /granite/quartzite/gneiss metal for R.C.C.columns as per detailed designs and drawing or as directed including centering,formwork,cover blocks (S- S.S.R. I.No. 25.31, P.No. 134)		
	ADD LEAD CHARGES FOR CEMENT	0.30000	148.81	44.64
	ADD LEAD CHARGES FOR SAND	0.44000	973.59	428.38
	ADD LEAD CHARGES FOR CR METAL	0.33000	355.50	117.32
	@ADD DIFF.COST FOR SAND	0.44000	825.00	363.00
	@ADD DIFF.COST FOR 20MM METAL	0.22000	174.00	38.28
	@ADD DIFF.COST FOR 12MM METAL	0.11000	174.00	19.14
	TOTAL RATE Rs.			13997.76 PerCu.M.

RATE ANALYSIS AS PER PWD SSR 2021-22

SR. NO.	DESCRIPTION OF ITEM	QTY.	NET LEAD CHARGES	RATE
6	Providing and laying Cast in situ /Ready Mix cement concrete M20 of trap/granite/quartzite/gneiss metal for R.C.C. beams and lintels as per detailed designs and drawings or as directed including (S- S.S.R..I.No. 25.50, P.No.135)			11483.00
	ADD LEAD CHARGES FOR CEMENT	0.35000	148.81	52.08
	ADD LEAD CHARGES FOR SAND	0.42500	973.59	413.78
	ADD LEAD CHARGES FOR CR METAL	0.85000	355.50	302.18
	@ADD DIFF.COST FOR SAND	0.42500	825.00	350.63
	@ADD DIFF.COST FOR 20MM METAL	0.57000	174.00	99.18
	@ADD DIFF.COST FOR 12MM METAL	0.28000	174.00	48.72
	TOTAL RATE Rs.			12749.57
7	Providing and laying Cast in situ /Ready Mix cement concrete M20 of trap/granite/ quartzite/gneiss metal for R.C.C. slab sand landings as per detailed designs and drawings including centering,formwork, cover blocks, (S.S.R. I.No. 25.70, P.No.135)			13943.00
	ADD LEAD CHARGES FOR CEMENT	0.35000	148.81	52.08
	ADD LEAD CHARGES FOR SAND	0.42500	973.59	413.78
	ADD LEAD CHARGES FOR CR METAL	0.85000	355.50	302.18
	@ADD DIFF.COST FOR SAND	0.42500	825.00	350.63
	@ADD DIFF.COST FOR 20MM METAL	0.57000	174.00	99.18
	@ADD DIFF.COST FOR 12MM METAL	0.28000	174.00	48.72
	TOTAL RATE Rs.			15209.57
8	Providing and laying Cast in situ /Ready Mix cement concrete M-20 of trap/granite/quartzite/gneiss metal for R.C.C. Chajja as per detailed designs and drawings including centering,formwork,cover blocks, compactiong, curing,finishing and roughening the surface if special (S.S.R.I.No. 26.05, P.No. 137)			13111.00
	ADD LEAD CHARGES FOR CEMENT	0.35000	148.81	52.08
	ADD LEAD CHARGES FOR SAND	0.42500	973.59	413.78
	ADD LEAD CHARGES FOR CR METAL	0.85000	355.50	302.18
	@ADD DIFF.COST FOR SAND	0.42500	825.00	350.63
	@ADD DIFF.COST FOR 20MM METAL	0.57000	174.00	99.18
	@ADD DIFF.COST FOR 12MM METAL	0.28000	174.00	48.72
	TOTAL RATE Rs.			14377.57
9	Providing and fixing in position TMT-FE-500 bar reinforcement of various diameters for R.C.C .pile caps, footings, foundations, slabs,beams, columns ,canopies, staircase, concrete chajja, lintels, eardie, copings (S.S.R. I.No.26.33, P.No. 139)			71778.00
	ADD LEAD CHARGES FOR STEEL	1.00000	148.81	148.81
	TOTAL RATE Rs.			71926.81
10	Providing uncoursed rubble masonry of trap/granite/quartzite/gneiss stones in cement mortar 1:6 in foundation and plinth of inner walls/in plinth of (S.S.R. I.No.28.01, P.No. 146)			4757.00
	ADD LEAD CHARGES FOR CEMENT	0.35000	148.81	52.08
	ADD LEAD CHARGES FOR SAND	0.42500	973.59	413.78
	ADD LEAD CHARGES FOR RUBBLE	0.47500	299.83	142.42
	@ADD DIFF.COST FOR SAND	0.32000	825.00	264.00
	TOTAL RATE Rs.			5629.28
11	Providing soling using 80mm. size trap metal in 15cm. layer including filling voids with crused sand/grit, ramming, watering etc. complete. Spec. no. As directed (S.S.R. I.No.21.40 P.No. 118)			1322.00
	ADD LEAD CHARGES FOR METAL	1.00000	355.50	355.50

RATE ANALYSIS AS PER PWD SSR 2021-22

SR. NO.	DESCRIPTION OF ITEM	QTY.	NET LEAD CHARGES	RATE	
	TOTAL RATE Rs.			1677.50	PerCU.M.
12	Filling in plinth and floors with contractors material/ brought from out side and approved by Engineer incharge in layers of 15 cm to 20 cm including watering (S.S.R.I.No. 21.37, P.No. 117)			550.00	
	ADD LEAD CHARGES FOR MURUM-HARD	1.00000	287.34	287.34	
	ADD DIFF.COST FOR MURUM-HARD	1.00000	37.00	37.00	
	TOTAL RATE Rs.			874.34	PerCu.M.
13	Providing masonry with conventional / Indian Standard type bricks in cement mortar 1:6 in foundation and plinth of inner walls / in plinth of external walls including <u>bailing out water manually, striking joints on unexposed</u> (S.S.R.I.No. 27.01, P.No.144)			7343.00	
	ADD LEAD CHARGES FOR CEMENT	0.35000	148.81	52.08	
	ADD LEAD CHARGES FOR SAND	0.42500	973.59	413.78	
	ADD LEAD CHARGES FOR BRICKS	0.47500	1771.32	841.38	
	@ADD DIFF.COST FOR SAND	0.32000	825.00	264.00	
	ADD DIFF.COST FOR BRICKS	475.000	0.50	237.50	
	TOTAL RATE Rs.			9151.74	PerCu.M.
14	Providing masonry with conventional / Indian Standard type bricks in cement mortar 1:6 in superstructure including striking joints, raking out joints, watering and (S.S.R.I.No. 27.05, P.No. 144)			7570.00	
	ADD LEAD CHARGES FOR CEMENT	0.35000	148.81	52.08	
	ADD LEAD CHARGES FOR SAND	0.42500	973.59	413.78	
	ADD LEAD CHARGES FOR BRICKS	0.47500	1771.32	841.38	
	@ADD DIFF.COST FOR SAND	0.32000	825.00	264.00	
	ADD DIFF.COST FOR BRICKS	475.000	0.50	237.50	
	TOTAL RATE Rs.			9378.74	PerCu.M.
15	Providing internal cement plaster 6 mm thick in a single coat in cement mortar 1:4 without neeru finish to concrete surface in all positions including scaffolding and (S.S.R.I.No. 32.01, P.No. 153)			191.00	
	ADD LEAD CHARGES FOR CEMENT	0.01000	148.81	1.49	
	ADD LEAD CHARGES FOR SAND	0.02000	973.59	19.47	
	@ADD DIFF.COST FOR SAND	0.02000	825.00	16.50	
	TOTAL RATE Rs.			228.46	PerSq.M.
16	Providing internal cement plaster 20 mm thick in single coat in cement mortar 1:5 without neeru finish to concrete or brick surfaces, in all positions including (S.S.R. I. No. 32.03 P. No. 153)			359.00	
	ADD LEAD CHARGES FOR CEMENT	0.01000	148.81	1.49	
	ADD LEAD CHARGES FOR SAND	0.02000	973.59	19.47	
	@ADD DIFF.COST FOR SAND	0.02000	825.00	16.50	
	TOTAL RATE Rs.			396.46	PerSq.M.
17	Providing sand faced plaster externally in cement mortar using approved screened sand, in all positions including base coat of 15 mm thick in cement mortar 1:4 using (S.S.R. I. No. 32.11 P. 153)			599.00	
	ADD LEAD CHARGES FOR CEMENT	0.01000	148.81	1.49	
	ADD LEAD CHARGES FOR SAND	0.02000	973.59	19.47	
	@ADD DIFF.COST FOR SAND	0.02000	825.00	16.50	
	TOTAL RATE Rs.			636.46	PerSq.M.

RATE ANALYSIS AS PER PWD SSR 2021-22

SR. NO.	DESCRIPTION OF ITEM	QTY.	NET LEAD CHARGES	RATE	
18	Providing and laying in situ cement concrete M20 with tremix treatment for 100 mm thickness for flooring with groove cutting of 4mm wide and 20mm deep with necessary refilling with bitumen etc. complete. (S.S.R. I. No. 33.30 P. 158)			746.00	
	ADD LEAD CHARGES FOR CEMENT	0.01000	148.81	1.49	
	ADD LEAD CHARGES FOR SAND	0.02000	973.59	19.47	
	ADD LEAD CHARGES FOR CR METAL	0.02000	355.50	7.11	
	@ADD DIFF.COST FOR SAND	0.02000	825.00	16.50	
	ADD DIFF.COST FOR CR METAL	0.02000	174.00	3.48	
				794.05	PerSq.M.
19	Providing and applying white-wash in two coats on old/new plastered or masonry surfaces and asbestos cement sheets including scaffolding and preparing the surface by brushing and brooming down etc. complete. (S.S.R. I. No. 32.34 P. 155)			11.00	
	TOTAL RATE Rs.			11.00	PerSq.M.
20	Providing & applying washable oil-bound distemper of approved colour and shade to old & new surfaces in two coat including scaffolding, preparing the surfaces. (S.S.R.I.No. 36.11, P. No. 167)			43.00	
	TOTAL RATE Rs.			43.00	PerSq.M.
21	Providing and applying two coats of exterior weather shield paint of approved manufacture and of approved colour to the plastered surfaces including cleaning ,preparing the plaster surface ,applying primer coat (S.S.R.I.No. 35.26, P. No. 165)			238.00	
	TOTAL RATE Rs.			238.00	PerSq.M.
22	Providing & constructing Brick Masonry Inspection Chamber 60cm x 45cm x 90cm including 1:4:8 cement concrete foundation 1:2:4 cement concrete channels (S.S.R. I.No. 42.10, P.No. 200)			12348.00	
	ADD LEAD CHARGES FOR CEMENT	0.35000	148.81	52.08	
	ADD LEAD CHARGES FOR SAND	0.42500	973.59	413.78	
	@ADD DIFF.COST FOR SAND	0.32000	825.00	264.00	
	ADD DIFF.COST FOR BRICKS	475.000	0.50	237.50	
	TOTAL RATE Rs.			13315.36	PerSq.M.
23	Providing and laying machine cut machine polished machine cut Kota stone slabs 20 to 25 mm thick for treads and risers of steps and staircases, with rounded nosing for the treads on a bed of 1:4 cement mortar including cement float, filling joints with neat cement (S.S.R. I.No.33.18 P. No. 157)			1493.00	
	ADD LEAD CHARGES FOR CEMENT	0.01250	148.81	1.86	
	ADD LEAD CHARGES FOR SAND	0.03300	973.59	32.13	
	@ADD DIFF.COST FOR SAND	0.03300	825.00	27.23	
	TOTAL RATE Rs.			1554.22	PerSq.M.
24	Providing and fixing in position powder coated aluminium louvered windows / ventilator of various sizes with powder coating as per detailed drawing and (S.S.R. I.No.39.68 P. No. 188)			3107.00	
	TOTAL RATE Rs.			3107.00	PerSq.M.
25	Providing and fixing rolling shutter fabricated from steel laths of minimum thickness 0.9mm with lock plate of 3.15mm thickness reinforced with 35x35x5 mm angle section fitted with sliding bolts and handles for both sides, deep M.S.channel section of depth and thickness not less than 65mm and 2.15mm respectively with hold				

RATE ANALYSIS AS PER PWD SSR 2021-22

SR. NO.	DESCRIPTION OF ITEM	QTY.	NET LEAD CHARGES	RATE
	(S.S.R. I.No. 38.05 P. No. 171)			4730.00
	TOTAL RATE Rs.			4730.00
26	Providing and fixing self supporting steel roofing system for a Godown or a like made up of structural grade steel sheet of 912 millimeter width (tolerance +/- 2 millimeter), moulded at site using mechanical press dies to the desired curve and shape to form 605 millimeter wide interlocking panels. The interlocking (S.S.R. I.No. 38.44 P. No. 231)			8680.00
	TOTAL RATE Rs.			8680.00
27	Providing and fixing 45 cm wide mild steel ladder of 40mmx6mm mild steel flat stringers and steps of 18 mm dia. Mild steel bar for water tank including fixing itin(1:2:4)M-15 cement concrete block 60cm x 30cm (S.S.R. I.No. 41.56 P. No. 198)			1151.00
	TOTAL RATE Rs.			1151.00
28	Conveying materials obtained from excavation including all lifts, laying in layers of 20cm. to 30cm. breaking clods, dressing to the required lines, curves, grades and section watering and compacting to not less than 97% of (S.S.R. I.No. 2.26 P. No. 24)			359.00
	TOTAL RATE Rs.			359.00
29	Providing preconstructional antitermite treatment as per I.S.6313(Part-II) by treating the top surface of plinth filling at the rate of 5 litres of emulsion concentrate at (S.S.R. I.No. 21.24 P. No. 117)			94.00
	TOTAL RATE Rs.			94.00
30	Providing and fixing corrugated galvanised iron sheets of 0.63mm thick (24 B.W.G.) for roofing without wind tiles including fastening with galvanised iron screws and (S.S.R. I.No. 38.05 P. No. 171)			1042.00
	TOTAL RATE Rs.			1042.00
31	Providing and fabricating structural steel work in rolled sections like joists, channels, angles, tees etc. as per detailed design and drawings or as directed including (S.S.R. I.No. 23.02 P. No. 129)			85585.00
	TOTAL RATE Rs.			85585.00
32	Compacting the hard murum side widths including laying in layers on each side with vibratory roller including artificial watering etc. complete. (S.S.R. I.No. 2.31 P. No. 24)			19.00
	TOTAL RATE Rs.			19.00
33	Compacting the subgrade/gravel/size metal (100 mm loose) layers for all widths with Power roller having weight 8 to 10 MT. including necessary, labour, materials and artificial watering complete. (S.S.R. I.No. 50.61 P. No. 250)			25.00
	TOTAL RATE Rs.			25.00
34	Providing and fixing lightening conductor system comprising of erecting Air-Termination consisting of tubular copper rod of 25mm dia. 1.2 mm thick with			2132.00
	TOTAL RATE Rs.			2132.00
35	ADA compliant modular Multilingual and tactile Emergency evacuation map of each floor indicating the current position of the viewer saying "YOU ARE HERE" of (S.S.R. I.No. 51.74 P. No. 261)			19750.00
	TOTAL RATE Rs.			19750.00

NAME OF WORK :- PROPOSED CONSTRUCTION OF DAL MILL SHED IN SURVEY NO.- 4. AT KESAPURI SHIVAR.
TQ. MAJALGAON , DIST. BEED

LEAD CHART (AS PER PWD SSR 2021-22)

SR. NO.	MATERIAL	TYPE OF MATERIAL	LOCATION OF QUARRY	LEAD IN KM.	LEAD CHARGES	INITIAL LEAD CHARGES	NET LEAD CHARGES
1	CEMENT	MANUAL	MAJALGAON	5.00	148.81	0.00	148.81
2	SAND	MACHINE	SHAHAGAD	70.00	973.59	0.00	973.59
3	CR METAL	MACHINE	LOCAL	15.00	355.50	0.00	355.50
4	40MM METAL CB	MACHINE	LOCAL	15.00	340.69	0.00	340.69
5	STEEL	MANUAL	MAJALGAON	5.00	148.81	0.00	148.81
6	BRICKS	MANUAL	LOCAL	45.00	1771.32	0.00	1771.32
7	MURUM-HARD	MACHINE	GAIRAN	10.00	287.34	0.00	287.34
8	RUBBLE	MACHINE	GAIRAN	10.00	299.83	0.00	299.83
9	GRANITE	MANUAL	MAJALGAON	5.00	14.88	0.00	14.88

NAME OF WORK :- PROPOSED CONSTRUCTION OF DAL MILL SHED IN SURVEY NO.- 4, AT
KESAPURI SHIVAR, TQ. MAJALGAON , DIST. BEED

DIFF.COST OF MATERIAL

SR. NO.	MATERIAL	RATE AS PER SSR OF 2021-22	MARKET RATE	EXCESS	LESS	REMARKS/ EFFECTIVE DATE
1	SAND	1575.00	2400.00	825.00	0.00	Rate As On
2	20MM METAL	996.00	1170.00	174.00	0.00	Rate As On
3	12MM METAL	996.00	1170.00	174.00	0.00	Rate As On
4	40MM METAL CB	991.00	850.00	0.00	141.00	Rate As On
5	BRICKS	8.00	8.50	0.50	0.00	Rate As On
6	MURUM-HARD	288.00	325.00	37.00	0.00	Rate As On

PRO - CON AGRO PRODUCER COMPANY LIMITED
SURVEY NO.- 23, AT BHATWADGAON, TQ. MAJALGAON, DIST. BEED

NAME OF WORK : PROPOSED CONSTRUCTION OF DAL MILL SHED IN SURVEY NO. 4, AT KEAPURI SHIVAR, TQ. MAJALGAON, DIST. BEED

ROYALTY STATEMENT

SR. NO.	ITEM OF WORK	EXECUTE QUANTITY	NATURAL SAND		CEMENT IN BAGS		METAL		RUBBLE		MURUM	
			FACTOR	QTY.	FACTOR	QTY.	FACTOR	QTY.	FACTOR	QTY.	FACTOR	QTY.
1	Providing and laying Cast in situ/Ready Mix cement concrete in M-10 of trap/ granite/ quartzite/ gneiss metal for foundation and	74.973	0.4700	35.24	4.40	329.88						
2	Providing and laying in situ/Ready Mix cement concrete M-20 of trap/ granite/quartzite/gneiss	33.480	0.4250	14.23	7.00	234.36						
3	Providing and laying Cast in situ /Ready Mix cement concrete M20 of trap	14.861	0.4250	6.32	7.00	104.03						
4	Providing and laying Cast in situ /Ready Mix cement concrete M20 of trap/granite/quartzite/gneiss metal for R.C.C.	20.947	0.4250	8.90	7.00	146.63						
5	Providing and laying Cast in situ /Ready Mix cement concrete M20 of trap/granite/ quartzite/gneiss metal for R.C.C. slab sand	2.580	0.4250	1.10	7.00	18.06						
6	Providing and laying Cast in situ /Ready Mix cement concrete M-20 of trap/granite/quartzite/gneiss metal for R.C.C.	4.050	0.4250	1.72	7.00	28.35						
7	Providing soling using 80mm. size trap metal in 15cm. layer including filling voids,with crused sand/grit, ramming, watering etc. complete.	56.803					1.16	65.89				
8	Filling in plinth and floors with contractors material/ brought from out side and approved by Engineer incharge in layers of 15 cm to 20	695.064									1.000	695.064
9	Providing masonry with conventional / Indian Standard type bricks in cement mortar 1:6 in foundation and plinth of inner walls / in plinth	18.601	0.3200	5.95	1.58	29.39						
10	Providing masonry with conventional / Indian Standard type bricks in cement mortar 1:6 in superstructure including striking joints, raking out joints, watering and scaffolding complete.	34.102	0.3200	10.91	1.58	53.88						
11	Providing internal cement plaster 6 mm thick in a single coat in cement mortar 1:4 without neeru finish to concrete surface in all positions	64.125	0.0150	0.96	0.17	10.90						
12	Providing internal cement plaster 20 mm thick in single coat in cement mortar 1:5 without neeru finish to concrete or brick surfaces in all	204.677	0.0150	3.07	0.17	34.60						
13	Providing sand faced plaster externally in cement mortar using approved screened sand, in all positions including base coat of 15 mm	292.266	0.0150	4.38	0.22	64.30						
				Total	92.783		1054.573		65.891		0.000	695.064

PRO - CON AGRO PRODUCER COMPANY LIMITED
SURVEY NO.- 23, AT BHATWADGAON, TQ. MAJALGAON , DIST. BEED

NAME OF WORK :- PROPOSED CONSTRUCTION OF DAL MILL SHED IN SURVEY NO.- 4, AT
KESAPURI SHIVAR, TQ. MAJALGAON , DIST. BEED

Royalty Charges Recovery Statements

Sr. No	Particulars	Required Quantity in Cum	Royalty Factor	Total Rate	Amount
1	SAND	92.78		237.370	22024.01
2	METAL Hand broken	65.89		216.180	14244.42
3	MURUM	695.06		216.180	150258.94
					186527.36

Pangave
S. S. Pangave
(B.E. Civil)
Consulting Civil Engineer
T. P. Latur / 643 / 2019
Mob. 8552085000

AREA STATEMENT :-

TOTAL PLOT AREA	4805 SQ.M.
BUP AREA OF DAL MILL SHED	438.96 SQ.M.
BUP AREA OF DRY&COOL PLT FRM	404.40 SQ.M.

SCHEDULE OF OPENING :-

RS	Rolling Shutter	3.40 X 2.90 M
V	Ventilator (louvred)	1.5 X 0.60 M

NAME OF WORK :-

PROPOSED CONSTRUCTION OF DAL MILL SHED IN SURVEY NO.-04, AT KESAPURI SHIVAR, TG. MAJALGAON, DIST. BEED

DATE :- 26/01/2022 SCALE:- 1:100, 1:200

COMPANY :-

PRO - CON AGRO PRODUCER COMPANY LIMITED

ARCHITECTS/ENGINEERS :-

Er. Shivshankar S. Pangave
(B.E. CIVIL)
(Reg. civil Engineer)
T.P. LATUR/643/2019
Shivam Consulting Engineers,
In front of ramkrushna mangal karyalaya, Kanheri Road,
moti nagar, Latur, 413512
Contact:- 6552085000

Sangam

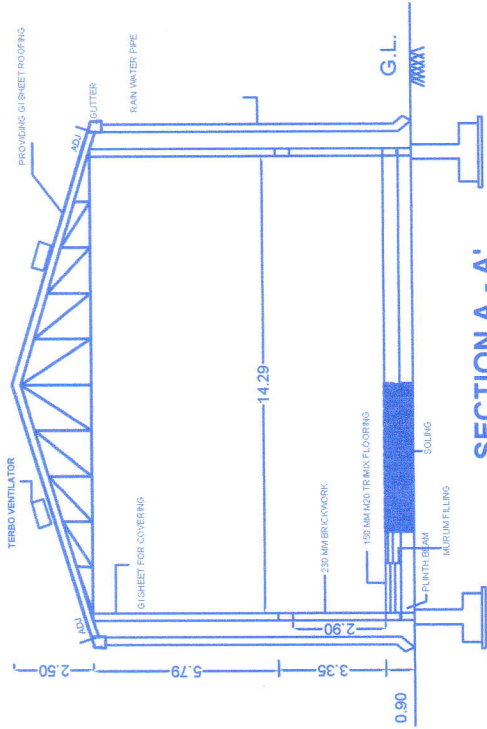

SECTION A - A'



BUILT UP AREA OF DAL MILL SHED
SCALE 1:200

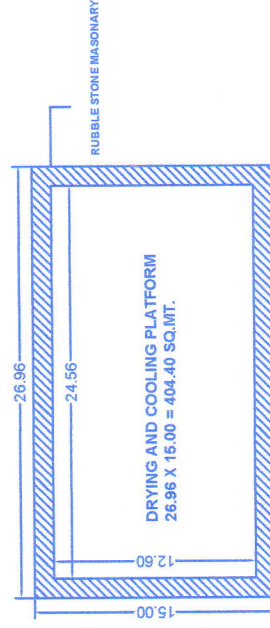

BUILT UP AREA OF DRYING AND COOLING PLATFORM
SCALE 1:200

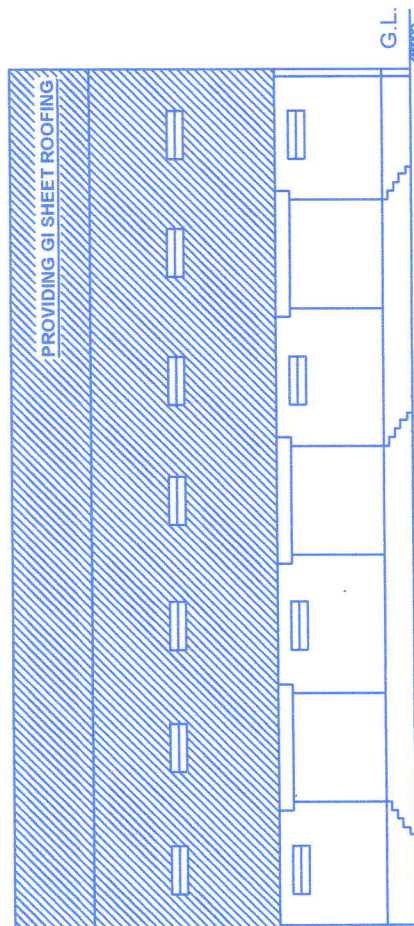

ELEVATION (EAST SIDE)

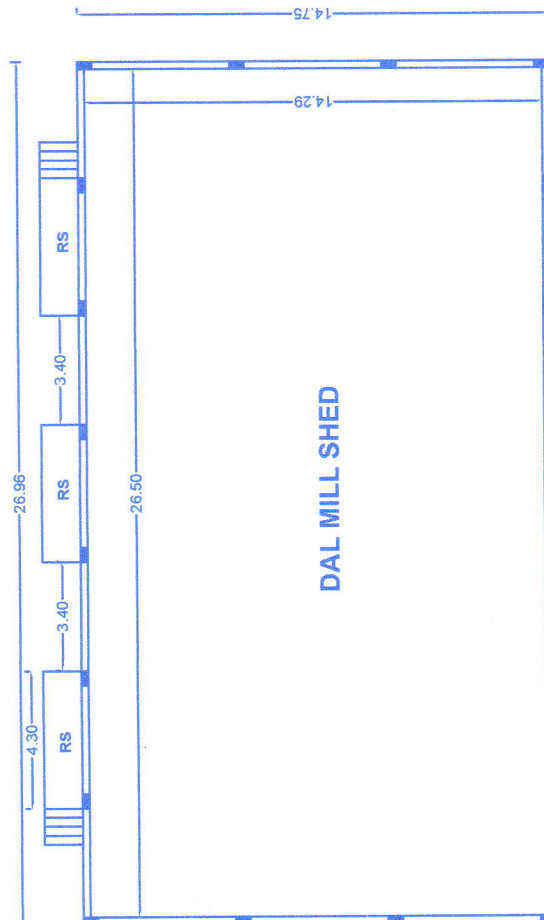

DAL MILL SHED

PLAN FOR DAL MILL SHED
SCALE 1:100

AREA STATEMENT :-	
TOTAL PLOT AREA	4805.00 SQ.M.
WAREHOUSE BUILT UP AREA	438.96 SQ.M.
DAL MILL SHED BUILT UP AREA	397.66 SQ.M.
COOLING AND DRYING PLATFORM BUILT UP AREA	404.40 SQ.M.
NAME OF WORK :- CONSTRUCTION OF WAREHOUSE & DAL MILL SHED IN SURVEY NO.- 04, AT KESAPURI SHIVAR, TG. MAJALGAON, DIST. BEED	
COMPANY :- PRO - CON AGRO PRODUCER COMPANY LIMITED	
DATE :- 27/01/2022	SCALE:- 1:100
SIGN OF ENGINEER :-  S. S. Pangave (P.E. CIVIL) Consulting Civil Engineer T. P. Lokeshwar, 1009 MIDC, MAJALGAON	

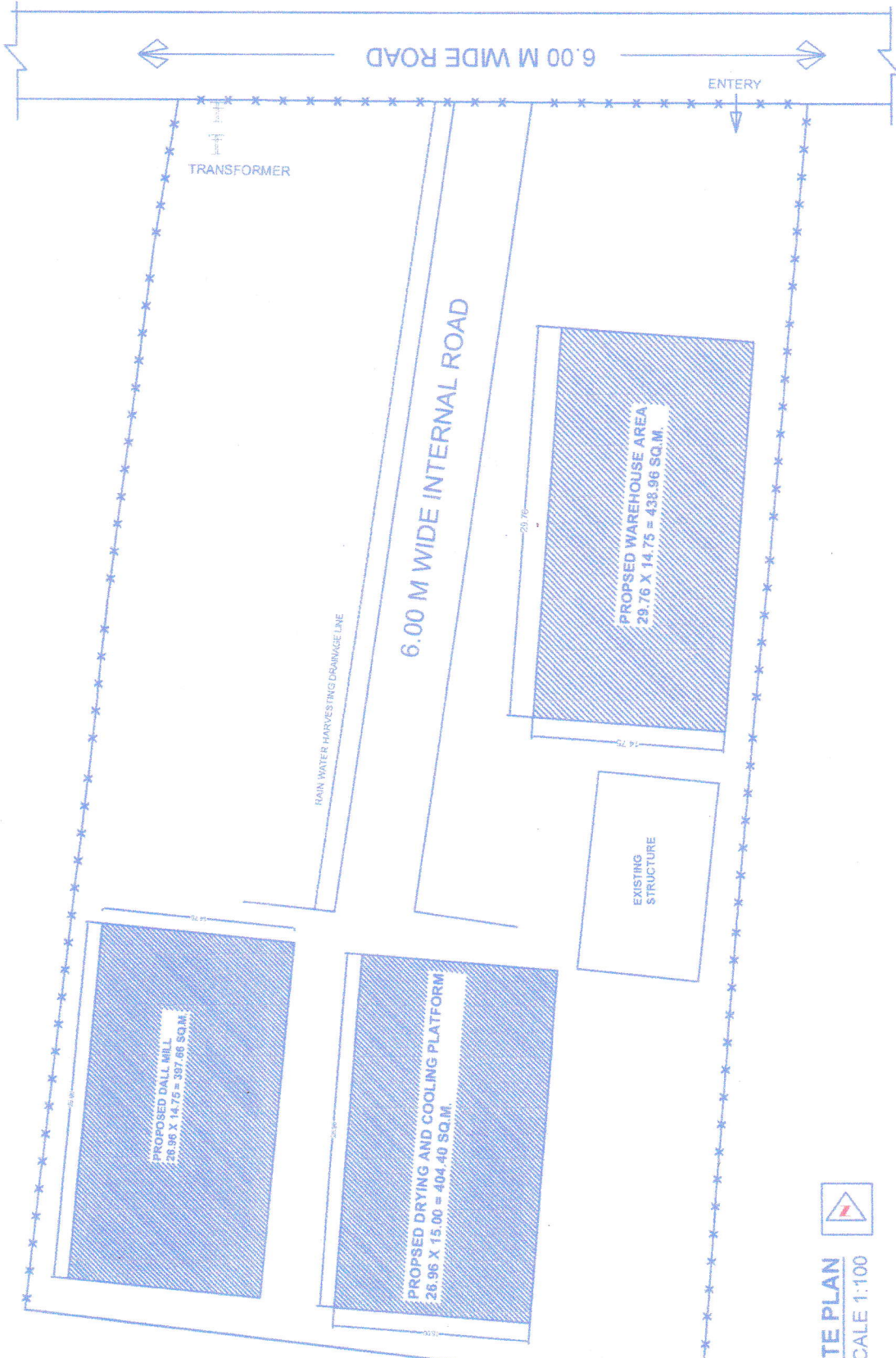

SITE PLAN
 SCALE 1:100

